

**STYLE No.**  
UNSD28, UNSD36, UNSD48

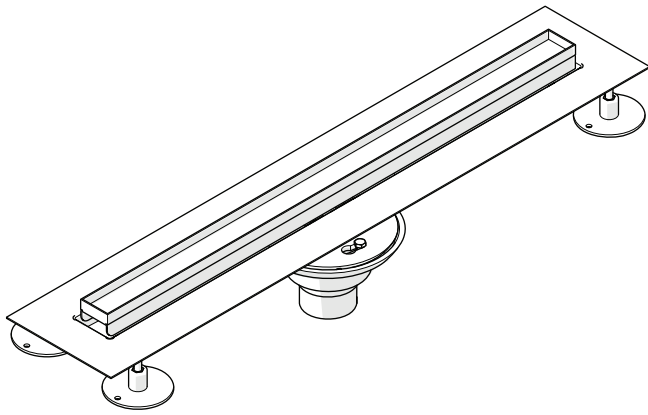

**SPECIFICATIONS:**

- Outlet Connection: 2" No Hub

**IMPORTANT:**

- To ensure this product is installed properly, you must read and follow these guidelines. The owner/user of this product must keep this information for future reference.
- This product must be on-site prior to rough-in. This allows the installer to visualize the installation and verify dimensions.
- This product must be installed by a professional licensed contractor. Be sure your installation conforms to all federal, state, and local codes. In the State of Massachusetts, all installations must comply with the rules and regulations set forth within 248 CMR.
- Refer to the specification and assembly drawings attached. Product is sold partially assembled but shown fully disassembled for illustrative and service purposes only.
- Inspect the product to ensure you have all the parts required for proper installation.

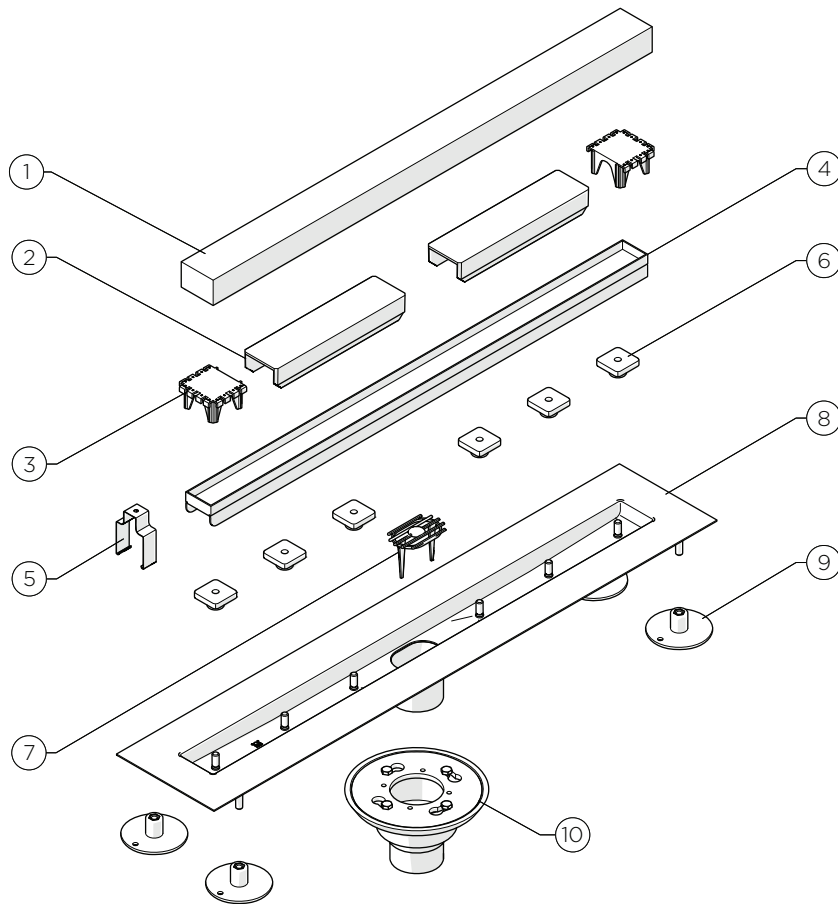

Item No.	Description	Qty
1	Mud Guard	1
2	Tile Guard	2
3	Straight Edge Frame Holder	2
4	Trim Cover	1
5	Removal Tool	1
6	Trim Cover Pad	6
7	Drain Strainer	1
8	Channel Drain	1
9	Adjustable Support Foot	4
10	2" No Hub Drain Body	1

**FIGURE - 01**

These guidelines have been prepared for the professional contractor to aid in the installation of:  
UNIVERSAL 28" CHANNEL SHOWER DRAIN (STYLE No. UNSD28), UNIVERSAL 36" CHANNEL SHOWER DRAIN (STYLE No. UNSD36) & UNIVERSAL 48" CHANNEL SHOWER DRAIN (STYLE No. UNSD48).  
 All dimensions are based on original specification and are subject to change and variation.  
 Please consult your Design Associate for current specifications.

**WATERWORKS**

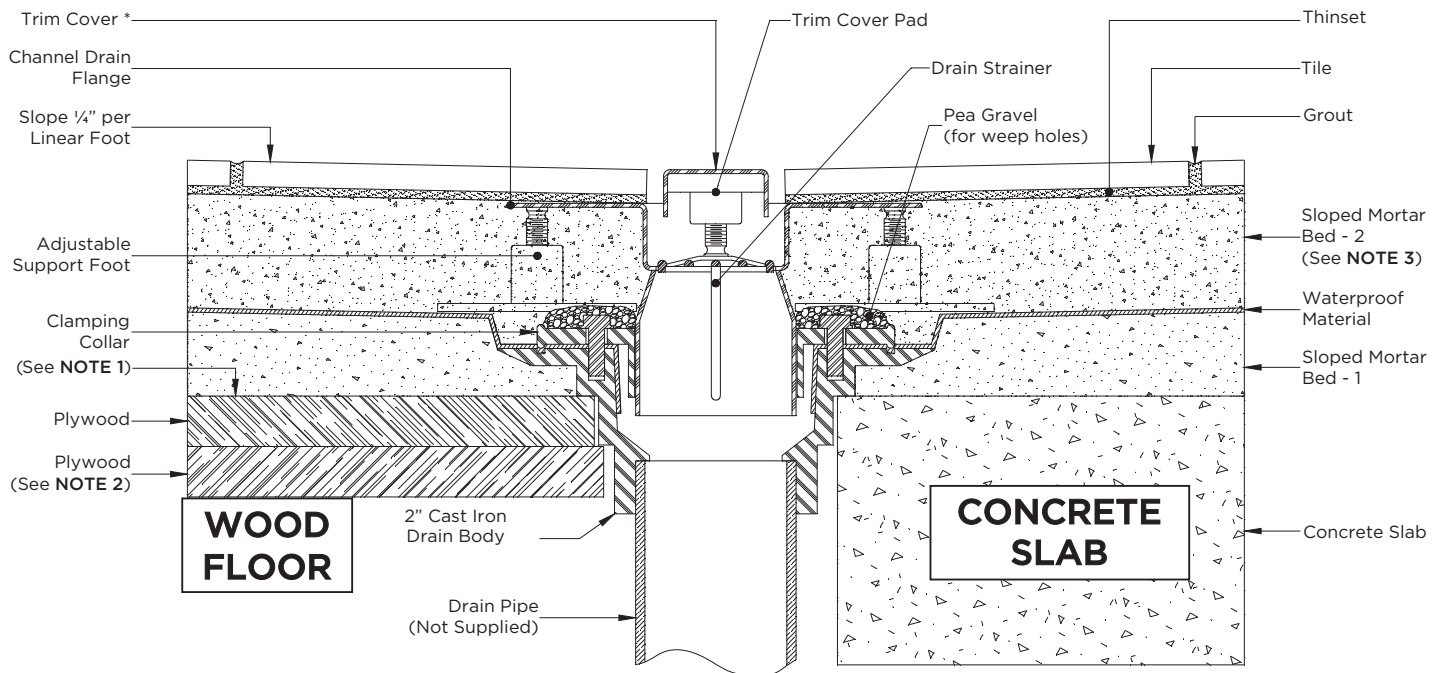

**NOTES:**

1. Moisture resistant material should be used between plywood and mortar base.
2. Floor (plywood) / joist structure should be of adequate strength to carry load from finished shower base.
3. Mortar base thickness shall be 1" minimum.

\* Tile Installation for Trim Cover

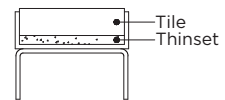

FIGURE - 02

**INSTALLATION:**

- Position the drain pipe so that the edges of the CHANNEL DRAIN are a minimum of 2" from the surface of the finished wall. See Figure - 03.

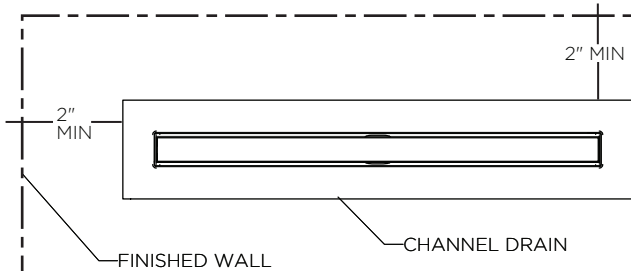

FIGURE - 03

- For wood sub-floor installations, see Figure - 02:
  - Install adequate blocking to properly support the 2" DRAIN BODY and strap the drain pipe (not supplied).
  - Cut a Ø3-5/8" hole in the sub floor to properly support the DRAIN BODY.
  - The throat of the 2" DRAIN BODY should pass through the sub-floor and the flange should rest on the sub-floor.

- For concrete slab installations, see Figure - 02:
  - Backfill with dirt and concrete around the 2" DRAIN BODY.

  1. Connect the 2" DRAIN BODY to the pre-installed drain pipe (not supplied) and perform a leak test conforming to all federal, state, and local codes. It may be necessary to trim the drain pipe to obtain the proper final installation height.
  2. Loosen the BOLTS and remove the CLAMPING COLLAR from the DRAIN BODY. See Figure - 04.

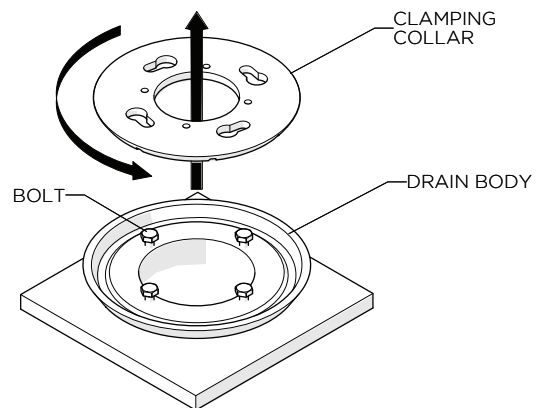

FIGURE - 04

These guidelines have been prepared for the professional contractor to aid in the installation of: UNIVERSAL 28" CHANNEL SHOWER DRAIN (STYLE No. UNSD28), UNIVERSAL 36" CHANNEL SHOWER DRAIN (STYLE No. UNSD36) & UNIVERSAL 48" CHANNEL SHOWER DRAIN (STYLE No. UNSD48). All dimensions are based on original specification and are subject to change and variation. Please consult your Design Associate for current specifications.

WATERWORKS

- Refer to Figure - 01 & 02 for Steps 3 - 16.
- 3. Apply mortar or similar material, pitched at a 1/4" per linear foot slope, over the sub-floor. The slope should begin at the shower walls and end at the DRAIN BODY.
- Do **NOT** apply mortar over the DRAIN BODY and take care to keep the drain opening free of any debris.
- 4. Install a waterproof material over the sloped mortar bed and DRAIN BODY. Install the waterproof material per the manufactures instructions conforming to all federal, state, and local codes.
- 5. Cut the waterproof material to expose the BOLTS and drain opening then re-attach the CLAMPING COLLAR and tighten the BOLTS. Ensure that the WEEP HOLES on the CLAMPING COLLAR are open and free of any excess waterproof material.
- 6. Perform a leak test of the waterproof material as described by the manufacturer conforming to all federal, state, and local codes.
- 7. Insert the CHANNEL DRAIN into the CLAMPING COLLAR and ensure that it is level.
- The CHANNEL DRAIN has 4 ADJUSTABLE SUPPORT FEET that can be used to level the DRAIN.
- 8. Place some pea gravel around the WEEP HOLES to prevent mortar from blocking them.
- It is necessary that the WEEP HOLES are open and free of building material to allow for proper water seepage.
- 9. Install the MUD GUARD to prevent debris and other materials from entering the CHANNEL DRAIN.
- 10. Apply a second mortar bed or similar material over the waterproof material at a 1/4" per linear foot slope. The slope should begin at the shower walls and end at the MUD GUARD.
- 11. Remove the MUD GUARD and install either the TILE GUARDS or the STRAIGHT EDGE FRAME HOLDERS.
- 12. Apply an appropriate amount of thinset, taking into account the minimum and maximum height of the TRIM COVER as shown in Figure - 05, and install the finished floor.
- It is important to install the finished floor flush to the TILE GUARDS or FRAME HOLDERS.
- When using the FRAME HOLDERS, the gap left between the frame and the finished floor must be filled with grout or similar material.

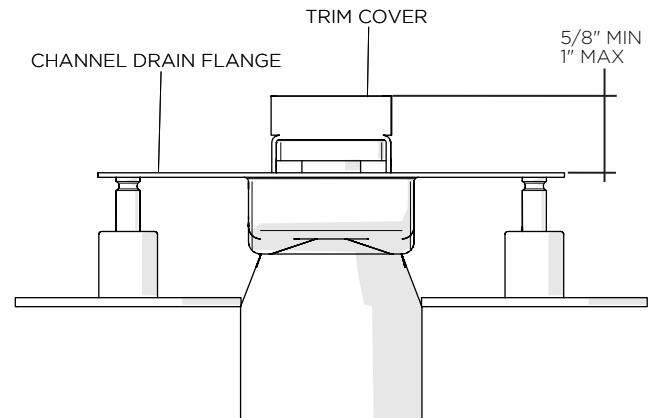

FIGURE - 05

- 13. Remove the TILE GUARDS or FRAME HOLDERS and install the DRAIN STRAINER.
- 14. Install the TRIM COVER PADS to an appropriate height and ensure they are level.
- 15. Apply an appropriate amount of thinset into the TRIM COVER to obtain the same height as the surrounding finished floor then install a rectangular piece of finished floor material into the TRIM COVER.
- 16. Place the TRIM COVER into the CHANNEL DRAIN and ensure that all the surfaces are level.
- If further assistance is required, please contact Product Support at 1-800-927-2120 Ext 2 Monday through Friday, 8am - 6pm EST.

These guidelines have been prepared for the professional contractor to aid in the installation of:  
UNIVERSAL 28" CHANNEL SHOWER DRAIN (STYLE No. UNSD28), UNIVERSAL 36" CHANNEL SHOWER DRAIN (STYLE No. UNSD36) & UNIVERSAL 48" CHANNEL SHOWER DRAIN (STYLE No. UNSD48).  
 All dimensions are based on original specification and are subject to change and variation.  
 Please consult your Design Associate for current specifications.

## WATERWORKS

# WATERWORKS



## CARE & CLEANING

The lustrous finish on your fitting, fixture, lighting or accessory should be treated with care as it is a living finish, meaning it will evolve over time. Most finishes will age gracefully and develop a unique patina depending on the climate, exposure, handling, cleaning, and waxing routine that is established.

For best results, please remember the following **General Cleaning Guidelines**:

Wash surfaces gently with a soft damp cloth; use a neutral liquid soap\* with water for daily cleaning. Rinse completely with water, dry any overspray. Never use an abrasive material such as a brush or scouring pad to clean surface. The use of abrasive cleaners, cleansers or disinfectants will alter the surface finish and void the warranty. \*Waterworks recommends Dawn® dishwashing detergent. Waterworks also recommends the general practice of spot testing all cleaning agents on an inconspicuous area prior to applying.

For those products for which waxing is recommended, a high quality clear carnauba paste wax routine is suggested twice annually to extend the life of a living finish. Note: the semi-annual wax routine is not recommended for all products. Please refer to the guidelines below for specific instructions. Note that prolonged contact with certain items such as toothpaste, air freshener, cologne, shaving cream, nail polish remover, vinegar, anti-bacterial soap and wines will also alter all surface finishes and void the warranty.

## CHARACTERISTICS AND CARE OF LIVING FINISHES

### CHROME, MATTE NICKEL, BURNISHED NICKEL, SOVEREIGN

Follow the general cleaning guidelines and the suggested semi-annual wax routine for these durable finishes.

### NICKEL

This durable finish will not change if the general cleaning guidelines are followed and the suggested semi-annual wax routine is performed. If you desire additional protection, the use of a decorative gel-gloss cleaner will aid in cleaning and protecting the surface. Waterworks recommends Faucet Brite® gel-gloss cleaner. The cleaner directions must be followed or the Waterworks warranty is voided.

### GOLD, MATTE GOLD

These finishes are more susceptible to wear caused by cleaning agents. Follow the general cleaning guidelines and the suggested semi-annual wax routine. The use of polishing agents will damage the finish and void the warranty.

### ARCHITECTURAL BRONZE, BRONZE, OLD BRONZE, CARBON

These finishes tend to show subtle wear by revealing the bronze undertones in the areas of use. Follow the general cleaning guidelines for these finishes and the suggested semi-annual wax routine. This will keep the finish close to its original hue and minimize the appearance of use. The use of polishing agents will remove the antique finish and void the warranty.

### UNLACQUERED BRASS, SHINY COPPER, PATINA BRASS, ANTIQUED NICKEL, ANTIQUED BRONZE

These finishes will age or patina with exposure, climate, and handling. A consistent cleaning and wax routine is necessary to keep each finish to its original luster. Please follow the general cleaning guidelines. The use of polishing agents will remove the patina and restore the metal to its original shine. Once removed, the patina will naturally redevelop with time and use.

### ANTIQUE COPPER, ANTIQUE BRASS

These finishes have been weathered, creating a patina that normally takes months to achieve. This patina will continue to develop and change with handling and exposure. Please follow the general cleaning guidelines. The use of polishing agents will remove the antique finish and void the warranty.

### IRON, GILDED IRON\*

Wipe surface gently with a soft damp or dry cloth. Never use an abrasive material such as a brush or scouring pad to clean surface. The use of abrasive cleaners or disinfectants will alter the surface finish and void the warranty.

\*Same instructions apply for Gilded Iron using a dry cloth only.

## CARE OF FIXTURES

Note: a wax routine should not be used on Waterworks fixtures unless specifically recommended below.

### VITREOUS CHINA and FIRECLAY

The general cleaning guidelines are recommended.

### ACRYLIC AND COMPOSITE BATHTUBS INTERIOR AND EXTERIOR, CAST IRON WITH ENAMEL INTERIOR

In addition to the general cleaning guidelines, a non abrasive basin tub and tile cleaner can be utilized for regular cleaning and disinfecting.

### CORIAN\*

In addition to the general cleaning guidelines, ammonia-based cleaners or commercially available solid surface cleaners will remove most dirt and residue from Corian® surfaces. Stubborn residue will require a slightly stronger cleaner. Follow the recommendations at [www.corian.com](http://www.corian.com) to properly clean your Corian® vanity top or washbasin.

# WATERWORKS



## CARE & CLEANING

### STAINLESS STEEL

Only the general cleaning guidelines are recommended for this finish. In addition, clean stainless steel once a week with a stainless steel cleaner. Always apply stainless steel cleaner with a nonabrasive cloth, working with, not across the grain.

### COPPER INTERIOR AND EXTERIOR

Copper will patina with exposure to climate and use. The general cleaning guidelines are recommended, as well as the semi-annual wax routine, to keep this finish close to its original luster.

### BURNISHED BATH TUB EXTERIOR

General cleaning guidelines are recommended for this exterior finish. For our Burnished tubs, it is also important to ensure the interior enamel surface and the exterior surface do not get chipped or scratched; this can result in the rusting of the cast iron and will void the warranty. If the tub will be stored for more than 30 days, it is recommended that the tub be stored in dry, ventilated conditions in temperatures not exceeding 95 degrees Fahrenheit or below 40 degrees Fahrenheit.

### WOOD FINISH

All wood furniture surfaces should be maintained with a soft damp cloth. Test cleaners in a discreet location first to ensure that there is no adverse reaction. Do not expose wood furniture to direct sunlight, drying heat sources or dampness. Dust frequently with a soft cloth in the direction of the grain. Use only products specifically made for cleaning wood. Avoid using oily polishes or waxes, or products containing silicone.

## CARE OF SURFACES

### MARBLE

All marble should be sealed with Miracle Sealants 511 Porous Plus after installation and periodically as needed. Clean the surface with a non abrasive, mild and PH neutral cleanser such as Miracle Sealant's Tile and Stone Cleaner. Do not use bleach, acidic cleaners, ammonia, abrasive or soft paste cleaners, vinegar, alcohol, window cleaners or lemon juice. In addition, do not use abrasive cleaning pads, steel wool, metal brushes or scouring pads. For marble or stone countertops, wipe up any remaining water off the deck of counter after use. Over time water can leave behind mineral deposits. When installing drains and fittings on marble countertops only use 100% silicone or marble safe plumbers putty. The use of incorrect putty will result in stained marble and void the warranty. For a thorough understanding on specific care and cleaning options, please refer to the TCNA (Tile Council of North America) at [www.tileusa.com](http://www.tileusa.com) and the MIA (Marble Institute of America) at [www.marble-institute.com](http://www.marble-institute.com). For more detailed Miracle Sealants product information visit [www.miraclesealants.com](http://www.miraclesealants.com).

### CERAMIC, GLASS, STONE AND CONCRETE

Grout joints should be sealed with Miracle Sealants 511 Porous Plus after installation and periodically as needed. It is recommended that all stone, concrete, sanded glass and crackle glazed ceramic should be sealed before and after installation. Non-sanded glass and non-crackled glazed ceramic do not require sealing (grout joints do require sealing). Clean the surface with a non-abrasive, mild and PH neutral cleaner such as Miracle Sealant's Tile and Stone Cleaner. Do not use bleach or acid cleaners, ammonia, abrasive or soft paste cleaners, vinegar, alcohol, window cleaner or lemon juice. In addition, do not use abrasive cleaning pads, steel wool, metal brushes or scouring pads. For marble or stone countertops, wipe up any remaining water off the deck of counter after use. Over time water can leave behind mineral deposits. When installing drains and fittings on stone countertops only use 100% silicone or marble safe plumbers putty. The use of incorrect putty will result in stained marble and void the warranty. For a thorough understanding on specific care and cleaning options, please refer to the TCNA (Tile Council of North America) at [www.tcnatile.com](http://www.tcnatile.com) and the MIA (Marble Institute of America) at [www.marble-institute.com](http://www.marble-institute.com).

## CARE OF FURNISHINGS

### BATH LINENS, LOUNGEWEAR

Please refer to our Textiles Care & Cleaning document.



## WARRANTY

### WARRANTY INFORMATION

Since 1978, Waterworks has been producing the finest products for the home in the world, providing highly personalized service and detailed support to help you achieve a smooth design and build experience. Every Waterworks product embodies our design integrity and aesthetic sensibility, the highest quality and craftsmanship and effortless functionality. All of our materials are the finest in their class. Attention to detail, quality and craftsmanship are an integral part of our manufacturing process. Our mode of manufacture is carefully controlled to create products to satisfy the most demanding tastes.

### REPAIR OR REPLACEMENT

The Waterworks warranty covers repair and replacement of Waterworks products. If within the applicable warranty period the covered products shall be proved to the satisfaction of Waterworks to be defective, Waterworks will, at its option, repair or replace such products provided that repair or replacement does not include installation costs, labor charges, or other incidental or consequential costs. If the products are used commercially the foregoing warranty is limited to a period of one (1) year from the date the product is purchased. All warranty claims must be made within the warranty period and must be accompanied by proof of purchase (original sales invoice). Products must be maintained and cleaned in accordance with the care or cleaning instructions, cleaning practices including without limitation the use of cleaners containing abrasive cleansers, ammonia, bleach, acids, waxes, alcohol, or solvents will void this warranty. Damage to a product caused by accident, misuse, or abuse is not covered by this warranty. Gloss reduction, scratching, staining, and alkaline etching of the finish over time due to use, cleaning practices, water, or atmospheric conditions are not manufacturing defects but are indicative of normal wear.

Waterworks' warranty obligations are subject to the conditions and limitations set forth in this warranty information statement.

### RESIDENTIAL LIFETIME LIMITED MECHANICAL WARRANTY

Waterworks warrants to the original purchaser or initial homeowner that all Waterworks plumbing and accessory products installed in a residence and used solely for residential purposes will be free of mechanical defects for as long as the original purchaser or initial homeowner continues to own and maintain the residence where the products are initially installed.

### FIVE YEAR LIMITED METAL FINISH WARRANTY

Waterworks warrants to the original purchaser or initial homeowner that the finish of all Waterworks plumbing and accessory products installed and used solely for residential purposes will be free from manufacturing defects in materials and workmanship for a period of five (5) years from the date of purchase of the products so long as the

purchaser continues to own and maintain the residence where the products are initially installed, provided that if the finish of the product is Architectural Bronze, Carbon, Gold, or Matte Gold, the foregoing warranty is limited to a period of two (2) years from the date on which the product is purchased.

### FIVE YEAR LIMITED WOOD FURNITURE WARRANTY

Waterworks warrants to the original purchaser or initial homeowner that all Waterworks wood furniture products installed in a residence and used solely for residential purposes will be free from manufacturing defects in materials and workmanship for a period of five (5) years from the date of purchase of the products so long as the purchaser continues to own and maintain the residence where the products are initially installed. Wood furniture will have natural variation in grain structure, color shade, and inherent characteristics such as streaks which are not considered defects.

### CAST IRON LIFETIME LIMITED FINISH WARRANTY

Waterworks warrants to the original purchaser or initial homeowner that the enamel surface of all Waterworks cast iron products used in a residence and used solely for residential purposes will be free of mechanical defects for as long as the original purchaser or initial homeowner continues to own and maintain the residence where the products are initially installed. In case of cast iron products with an exterior painted surface, the foregoing warranty is limited to a period of five (5) years from the date of purchase. In the case of cast iron products with a primed exterior surface, the foregoing warranty is limited to a period of one (1) year from the date of purchase and is conditional upon the proper finishing of the exterior surface of such product following adequate painting procedures prior to installation.

### ONE YEAR LIMITED ELECTRICAL TUB COMPONENTS, WATER CLOSETS AND VITREOUS CHINA WARRANTY

Waterworks warrants to the original purchaser or initial homeowner that all Waterworks electrical tub components, vitreous china, and watercloset internal components installed in a residence and used solely for residential purposes will be free from manufacturing defects in materials and workmanship for a period of one (1) year from the date of the purchase of the products so long as the purchaser continues to own and maintain the residence where the products are initially installed.

### STEAM GENERATOR FIVE-YEAR LIMITED WARRANTY

Waterworks warrants to the original purchaser or initial homeowner that all Waterworks steam generators and control products installed in a residence and used solely for residential purposes will be warranted to be free of manufacturing defects in material and workmanship for a period of five (5) years so long as the purchaser continues to own and maintain the residence where the products are initially installed.



# WATERWORKS



## WARRANTY

### LIMITATIONS ON WARRANTY COVERAGE

The warranties set forth above shall be extended only to the original purchaser or initial homeowner, and apply only to products purchased after May 12, 2014, and do not apply to any products used in whole or in part for commercial purposes unless otherwise noted. The warranties do not apply to:

- Damage caused by normal wear and tear;
- Products which have been repaired, altered or modified in any way by the original purchaser or any person other than Waterworks, unless previously authorized in writing by Waterworks;
- Products repaired with parts other than original Waterworks service parts, unless previously authorized in writing by Waterworks;
- Products which have been installed, used, maintained or stored other than in accordance with the care and cleaning guidelines, installation guidelines and or product specifications provided to the purchaser by Waterworks;
- Products which have been used for purposes other than or in a manner contrary to the intended and normal use;
- Products that have been used outdoors;
- Products which have been damaged as a result of misuse, negligence, freezing, accidental or faulty installation or maintenance;
- Products damaged by the effects of dirt, salt water, air, hard water, lime scale, or abrasive or aggressive cleaners;
- Products damaged from exposure to extremes of high or low humidity and/or to rapid temperature change as well as variations in appearance which result from the normal expansion and contraction of wood as it responds to climatic changes in the home;
- Products installed in a manner that does not comply with local code requirements; or
- Products sold "as is" and from store displays.

If the normal life span of any product is shorter than the applicable warranty period, the warranty shall apply only during the period of such shorter life span. In no event shall Waterworks be liable for any indirect, special, incidental or consequential damages or losses (including damages for loss of business, loss of profits, or the like) incurred by the purchaser. In no event shall the liability of Waterworks under the warranty for any product exceed the purchase price of the product. For any discontinued product or part with a warranty period of longer than ten years, Waterworks' warranty obligation shall expire on the earlier of ten years after the date of purchase of such product or part, or such time as a replacement product or part is no longer reasonably available to Waterworks.

**IMPLIED WARRANTIES INCLUDING THAT OF MERCHANTABILITY AND FITNESS FOR A PARTICULAR PURPOSE ARE EXPRESSLY LIMITED IN DURATION TO THE DURATION OF THIS WARRANTY. WATERWORKS AND/OR SELLER DISCLAIMS ANY LIABILITY FOR SPECIAL, INCIDENTAL OR CONSEQUENTIAL DAMAGES.**

Some states/provinces do not allow limitations on the duration of an implied warranty, or the exclusion or limitation of special, incidental or consequential damages; where this is the case these limitations and exclusions may not apply to you. This warranty gives you specific legal rights. You may also have other rights which vary from state/province to state/province. While Waterworks uses reasonable efforts to include accurate and up-to-date information and photographs in the catalog and on the website, Waterworks makes no warranties or representations as to the accuracy of this information and these photographs. Waterworks assumes no liability or responsibility for any errors or omissions in the content or photographs in the catalog or on the website. Waterworks is a registered trademark of Waterworks Operating Co., LLC

### WARRANTY SERVICES CONTACTS

Mail..... 60 Backus Avenue, Danbury, CT 06810, U.S.A.  
Email..... psticket@waterworks.com  
Phone (US)..... 1-800-927-2120  
Phone (UK)..... 0800-917-9116

